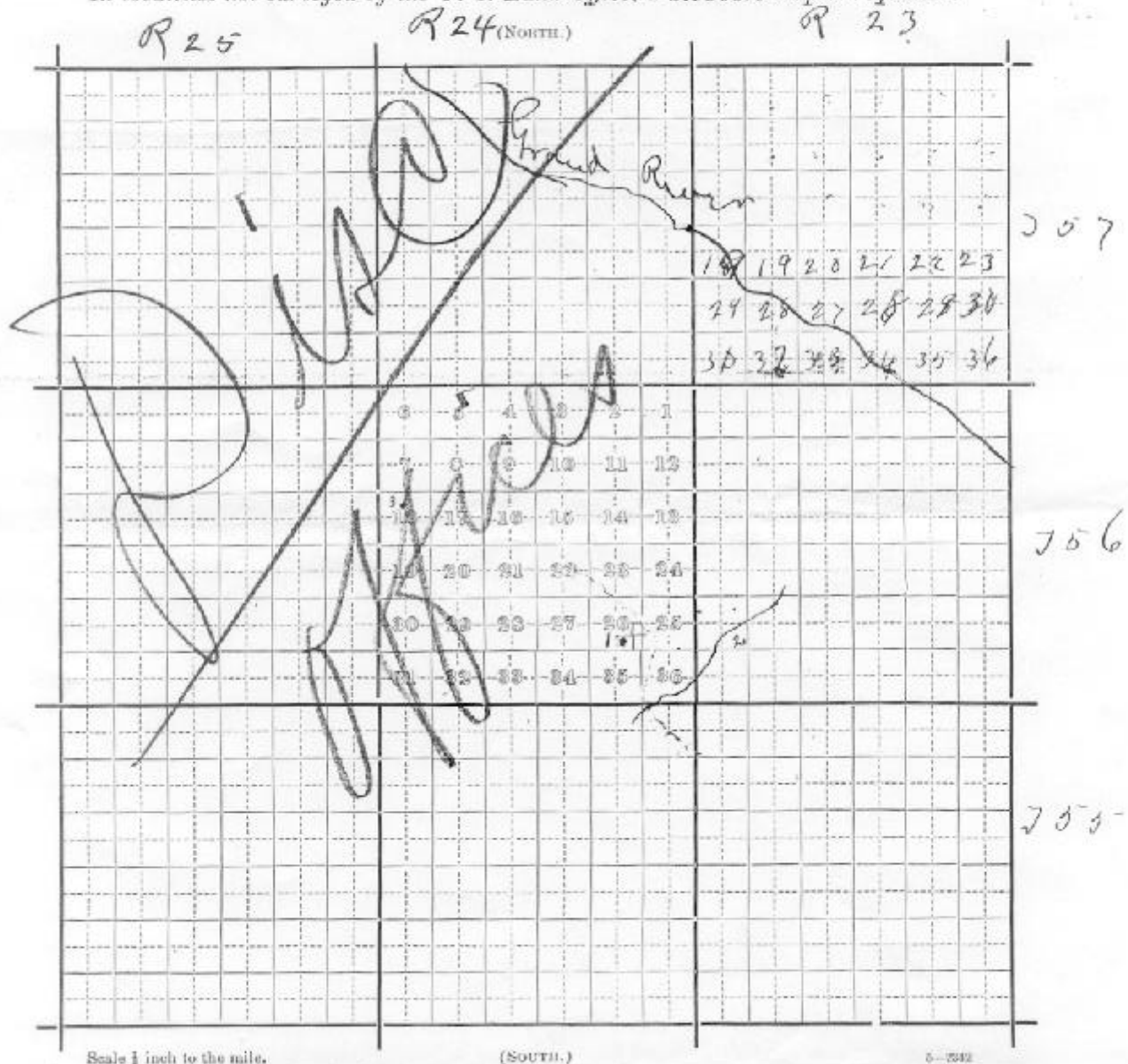

Diagram showing the site of the Blue Mound Post Office  
 in Township 56 N (N. or S.), Range 24 W (E. or W.),  
 of 5 Principal Meridian, County of Lumpkin, State  
 of Missouri, with the adjacent Townships and Post Offices.

It is requested that the exact site of your Post Office, as also the roads to the adjoining  
 Offices, and the rivers and creeks, be marked on this diagram, to be returned as soon as possi-  
 ble to the Topographer's Office, Post Office Department. If on, or near a railroad, mark  
 the railroad and adjacent Station accurately.

In localities not surveyed by the U. S. Land Office, a sketch map is requested.



- 1 Blue Mound P.O.
- 2 Mound Creek
- 3 Grand River